

# Workspace One Android Enrollment for AHN

Go to the Google Play Store and search for the Intelligent Hub and tap install.  
Tap open once it is installed

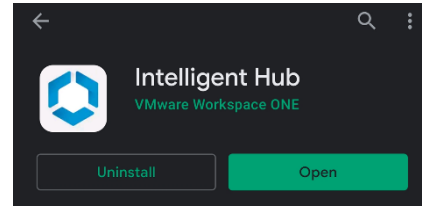

Enter in your Email Address and tap Next

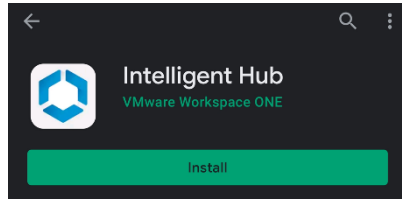
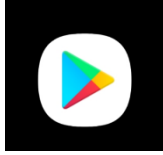
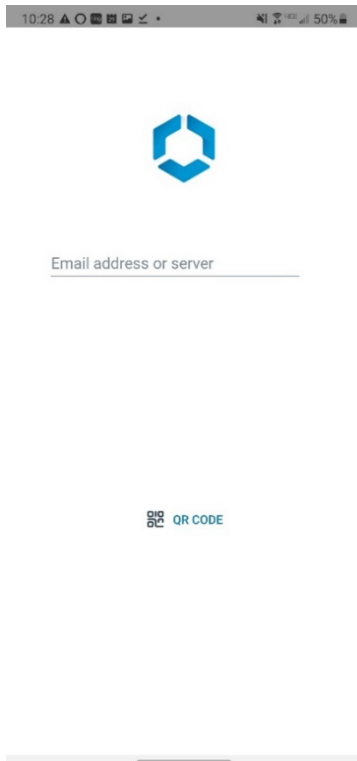

Enter in your Email Address again and tap Next

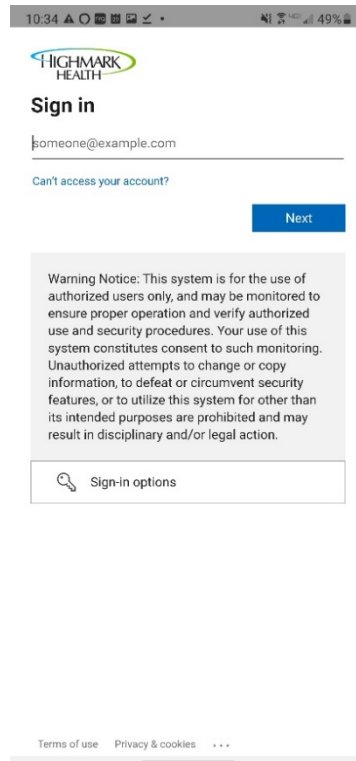

Enter your computer login password and tap Sign in

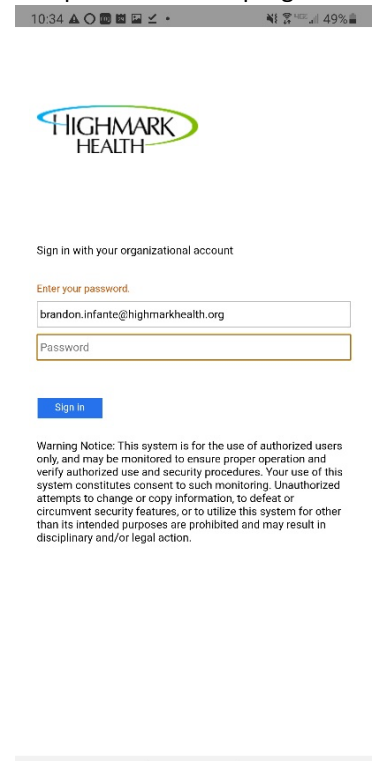

You will need to approve your sign in with the Microsoft Authenticator app. Go back to the intelligent hub immediately after approving your sign in

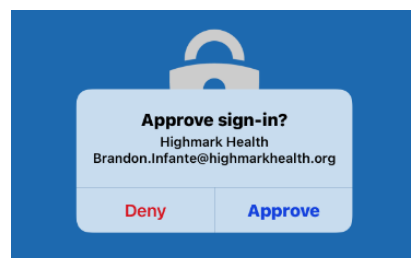
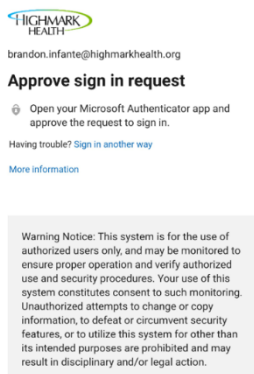

Back in the HUB App: Tap I understand

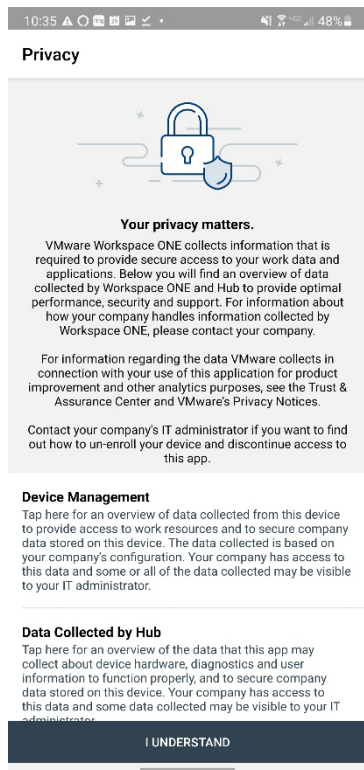

Tap I agree

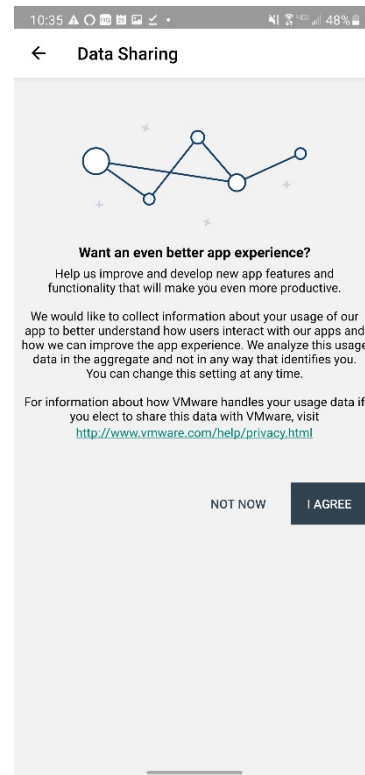

Intelligent hub will now create a work Profile on your device. Tap Agree

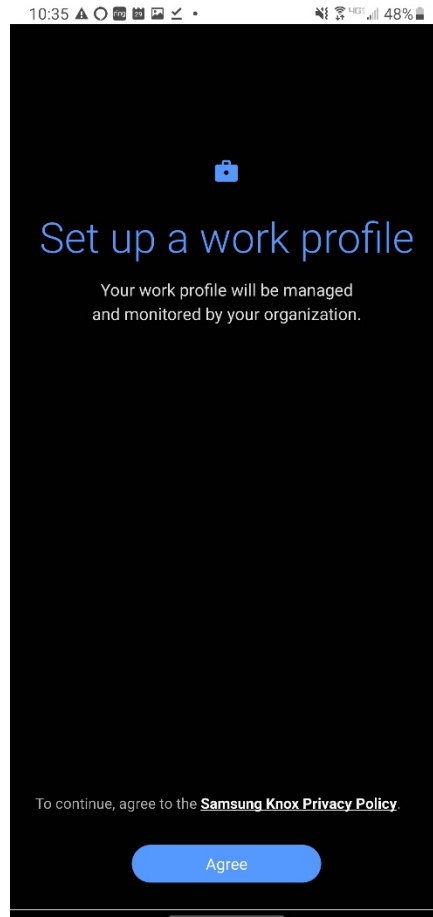

Tap **Skip**

You are done installing the intelligent Hub when you see this screen

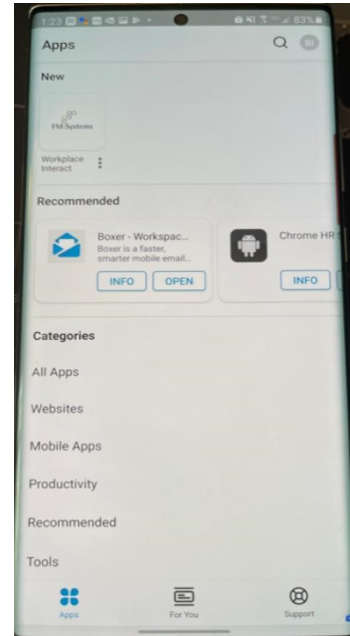
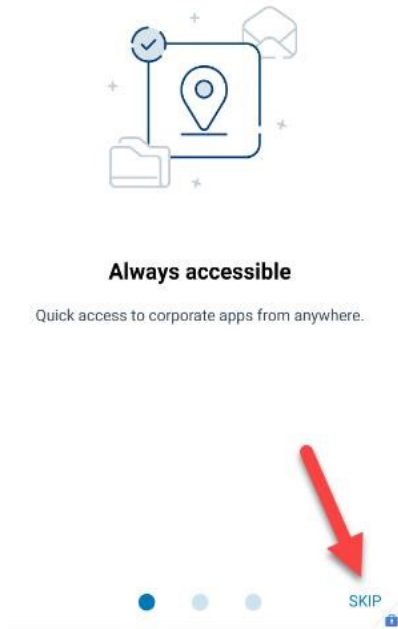

Go to your app library on your device and now you will see a **Personal and Work** profile at the bottom of the screen. Tap on **Work** profile and then tap on **Outlook** to open it

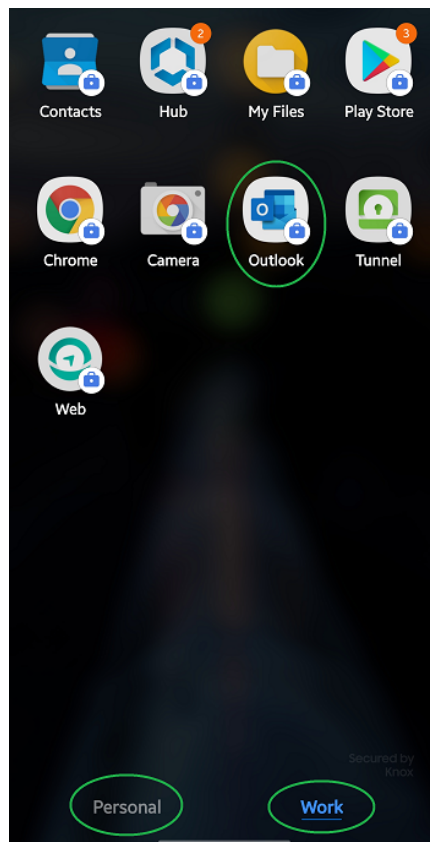

Tap Add Account

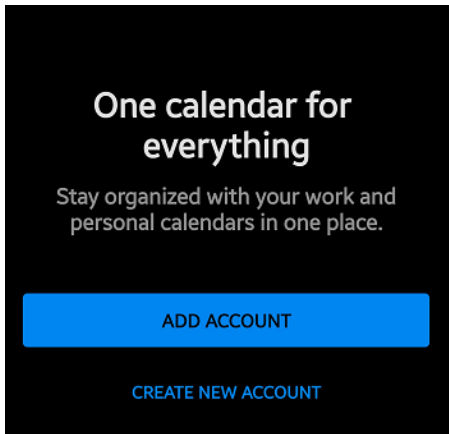

Tap Continue

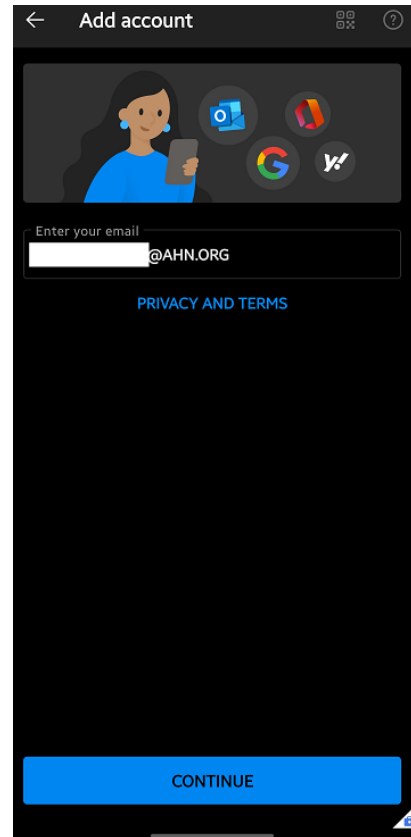

Enter you computer log in password and tap on the check  
at the upper right hand corner.

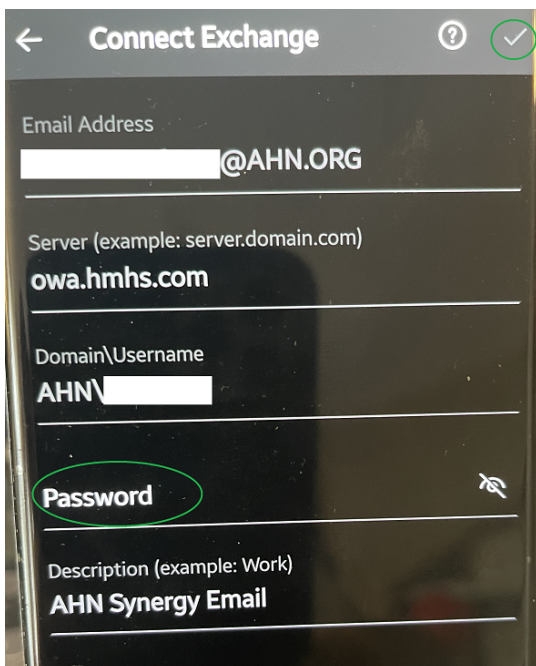

Tap "Maybe later"

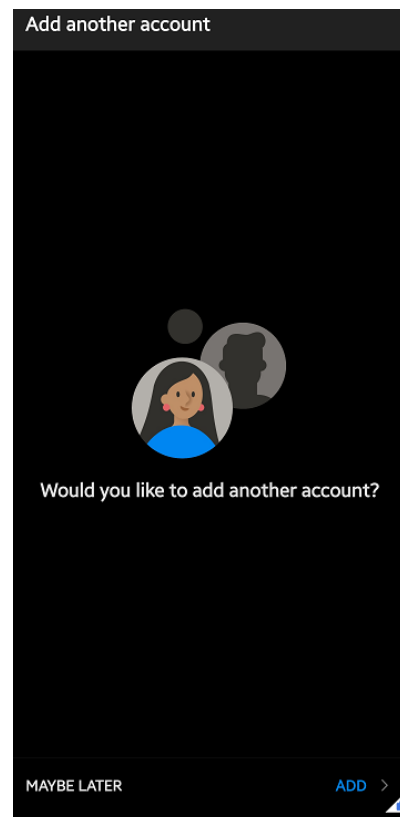

Your Email and Calendar will populate now.

